



DIN 933

ISO 4017

8.8

Standard withdrawn

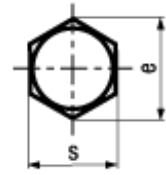
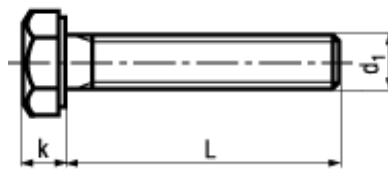

BN 56

Hex head screws

fully threaded

Steel 8.8

zinc plated blue

- ~UNI 5739
- ~CSN 021103

M10; M12; M14; M22: wrench size according to ISO on request

Article#	d ₁	e	k	s	L
3059303	M3	6,01	2	5,5	5
1048856					6
1048864					8
1048872					10
1048880					12
1048899					(14)
1048902					16
1048910					20
1048929					25
1048937					30
1048945	M4	7,66	2,8	7	6
1048953					8
1048961					10
1048988					12
1048996					(14)
1049003					16
1049011					(18)
1049038					20
1049046					(22)
1049054					25
1049062					30
1049070					35
1049089					40
5402631					50
1049186	M5	8,79	3,5	8	6
1049194					8

M10; M12; M14; M22: wrench size according to ISO on request

Article#	d ₁	e	k	s	L
1049208	M5	8,79	3,5	8	10
1049216					12
1049224					(14)
1049232					16
1049240					(18)
1049259					20
1049267					(22)
1049275					25
1049283					30
1049291					35
1049305					40
1049313					45
1049321					50
5402632					60
3059304	M6	11,05	4	10	6
1049437					8
1049445					10
1049453					12
1049461					(14)
1049488					16
1049496					(18)
1049518					20
1049526					(22)
1049534					25
1049542					30
1049550					35
1049569					40
1049577					45
1049585					50
1115065					55
1049593					60
5504385					65
1049607					70
1049615					80
1049623					90
1049631					100
3059307	M8	14,38	5,3	13	8
1049755					10
1049763					12
1049771					(14)
1049798					16

M10; M12; M14; M22: wrench size according to ISO on request

Article#	d ₁	e	k	s	L
1049801	M8	14,38	5,3	13	(18)
1049828					20
1049836					(22)
1049844					25
1049852					(28)
1049860					30
1049879					35
1049887					40
1049895					45
1049909					50
1049917					55
1049925					60
5402633					65
1049933					70
5402634					(75)
1049941					80
1049968					90
1049976					100
5504390					110
3059309					120
1050184	M10	18,9	6,4	17	10
1050192					12
1050206					(14)
1050214					16
1050222					(18)
1050230					20
1050249					(22)
1050257					25
1050265					30
1050273					35
1050281					40
1050303					45
1050311					50
1050338					55
1050346					60
1050354					65
1050362					70
5402662					(75)
1050370					80
1050389					90
1050397					100

M10; M12; M14; M22: wrench size according to ISO on request

Article#	d ₁	e	k	s	L
5402663	M10	18,9	6,4	17	110
1050400					120
3092500					130
5402665					140
5402666					150
1050621	M12	21,1	7,5	19	(14)
1050648					16
1050656					20
1050664					(22)
1050672					25
1050680					30
1050699					35
1050702					40
1050710					45
1050729					50
1050737					55
1050745					60
1050753					65
1050761					70
5402667					(75)
1050788					80
1050796					90
1050818					100
5402668					110
1050826					120
5402669					130
5402670					140
3092501					150
1051024	(M14)	24,49	8,8	22	20
1051032					25
1051040					30
1051059					35
1051067					40
1051075					45
1051083					50
1051091					55
1051105					60
1051113					70
1051121					80
8110778					90
3059312	M16	26,75	10	24	20

M10; M12; M14; M22: wrench size according to ISO on request

Article#	d ₁	e	k	s	L
1051253	M16	26,75	10	24	25
1051261					30
1051288					35
1051296					40
1051318					45
1051326					50
1051334					55
1051342					60
5402637					65
1051350					70
5402638					75
1051369					80
1051377					90
1051385					100
5504409					110
1051393					120
5402639					130
5402640					140
3092067					150
8269025					180
8268983					250
5402651	(M18)	30,14	11,5	27	30
5402652					35
1051563					40
1051571					45
1051598					50
1051601					55
1416111					60
5402653					70
5402654					80
8224242					100
1051717	M20	33,53	12,5	30	30
1051725					35
1051733					40
1051741					45
1051768					50
1051776					55
1051784					60
5402655					65
1051792					70
5402656					(75)

M10; M12; M14; M22: wrench size according to ISO on request

Article#	d ₁	e	k	s	L
1051806	M20	33,53	12,5	30	80
1051814					90
1051822					100
5504412					110
5504415					120
5504416					130
5512189					140
3092502					150
5512190					160
5504417					180
5504418					200
8223580					220
5402674	(M22)	35,72	14	32	50
5402675					60
5402677					70
5402678					80
1051997	M24	39,98	15	36	40
1052004					45
1052012					50
1052020					55
1052039					60
1052047					65
1052055					70
5402658					80
3092503					90
5402660					100
5509988					110
5402661					120
8213089					140
1052187	M30	50,85	18,7	46	60
1052195					70
3189442					(75)
1052209					80
5504448					90
5504449					100
8211043					110
5516080					120
8211051					140
8211078					160
8211086					220